

Fun with LEGO®/DUPLO

Activity Table

Your new activity table is designed to work with both LEGO and DUPLO pieces. It also has convenient storage pockets built right into the tabletop, allowing easy access to the pieces...and making cleanup a breeze!

What's Included

- LEGO/DUPLO tabletop
- 4 hardwood legs
- 8 wooden dowels
- 8 furniture bolts
- 8 barrel nuts

Note: To attach the legs to the tabletop, you will need a Phillips screwdriver and a standard screwdriver.

Assembly Instructions

1. Set the tabletop on its side.

2. Insert two wooden dowels and two barrel nuts into one of the legs, as shown. **Note:** Make sure the slotted ends of the barrel nuts are facing out.

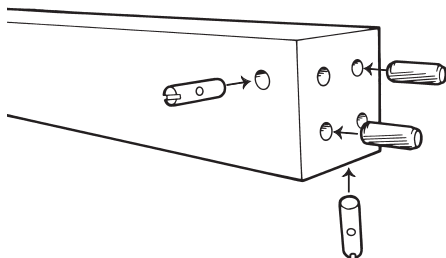

3. Align the wooden dowels with the holes on the bottom of the table and press the leg into the tabletop. **Note:** Make sure the holes for the barrel nuts face in, as shown.

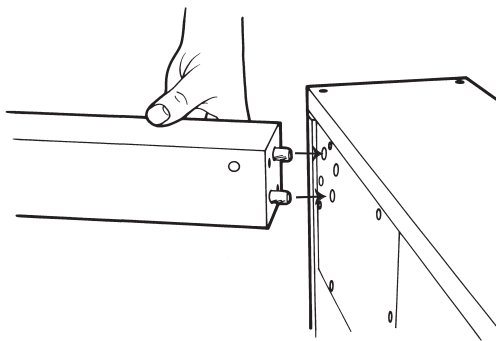

(continued on back)

4. Slide a furniture bolt through each predrilled hole in the tabletop pocket.

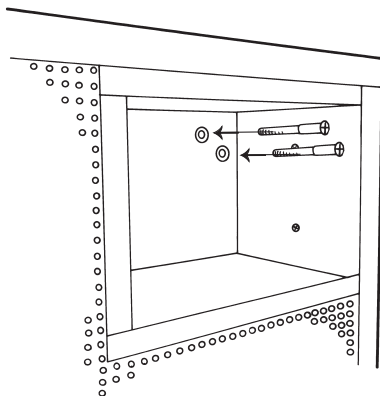

5. Hold one of the furniture bolts in place with one hand. Using a standard screwdriver, slowly rotate the barrel nut until the furniture bolt slides into place. Now, using a Phillips screwdriver, tighten the furniture bolt. Repeat for the other furniture bolt.

6. Repeat Steps 2 through 5 with the remaining legs.

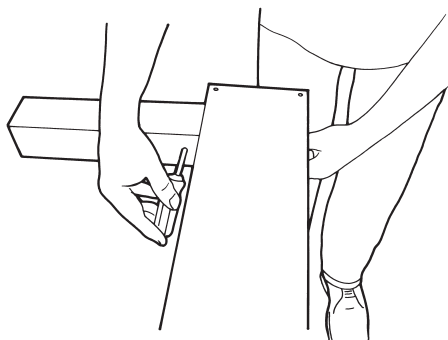

These products are not made by, authorized by or associated with the LEGO group.
LEGO and DUPLO are registered trademarks owned by KIRKBI AG.