



Easy-Ride™ First Trike

Engineered to stay on the move—all day, every day, year after year—your First Trike is one of the most durable institution-quality vehicles available. And it's guaranteed for five full years!

The trike features pedals designed to provide a secure foothold, plus lightweight rims and tires that make it easy to maneuver. Two 6" rear wheels provide extra stability for first-time pedalers. And, for children who are not quite ready for pedaling, the low seat height allows the trike to be used as a "walking trike."

Easy-Ride First Trike Unlimited Warranty

*We think you've just purchased the toughest First Trike in the world.
Here's what we'll do to prove it!*

At no cost, we will replace ANY parts that break for ANY reason during the first five years you have the Easy-Ride First Trike.

We have a complete stock of all Easy-Ride First Trike parts so that you can buy anything you need from us after this warranty expires. See the parts list inside.

Direct all requests to: Lakeshore Learning Materials
2695 E. Dominguez St.
Carson, CA 90895
(800) 428-4414

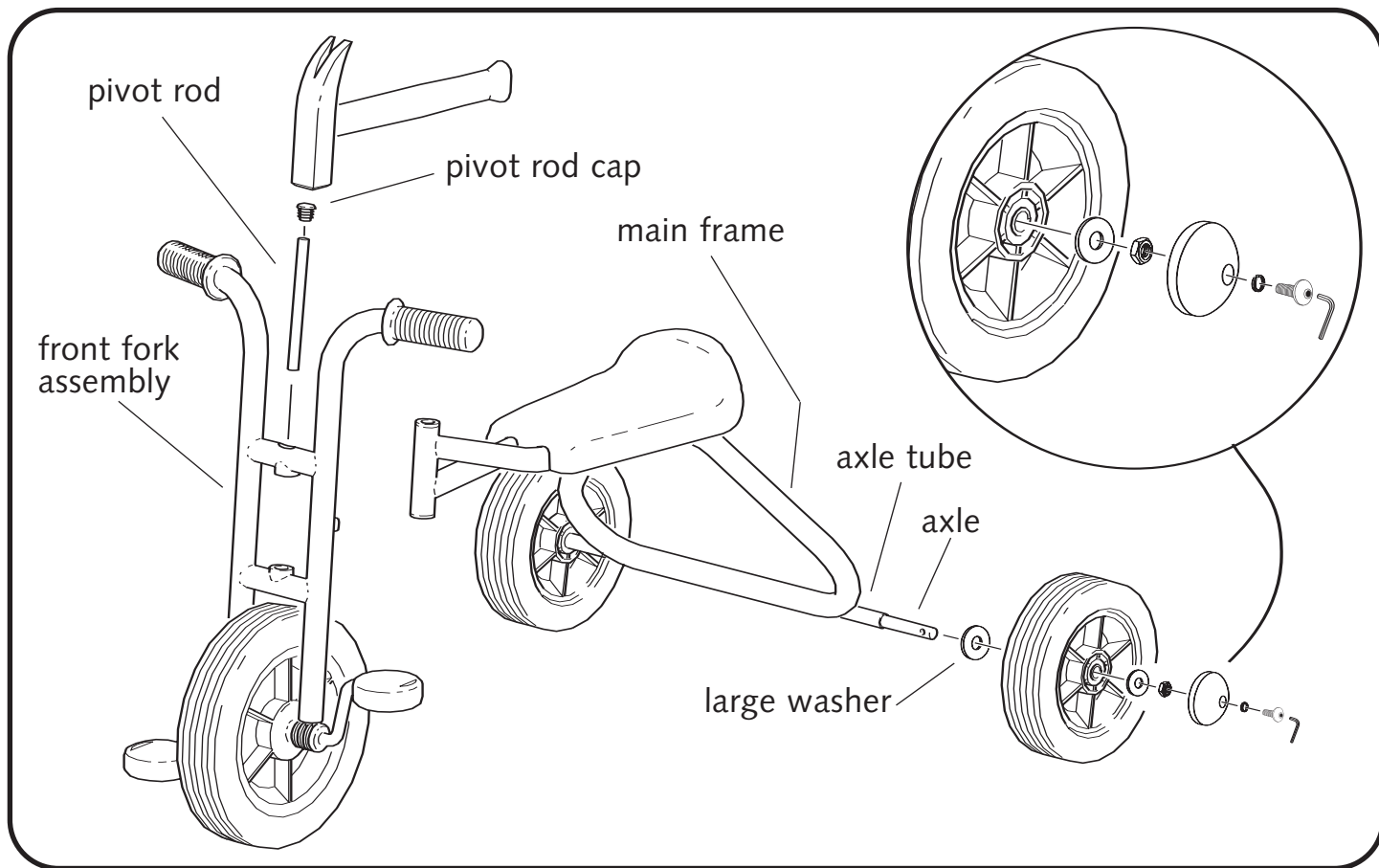

How to Assemble Your Easy-Ride First Trike

To assemble your trike, all you need is a rubber mallet or a hammer. (We've provided a wrench and an Allen key.)

- Position the front fork assembly and the main frame so that the pivot rod holes are aligned. Be sure the black rubber stoppers on the front fork assembly are facing the rear of the trike. Next, insert the pivot rod through the holes in the front fork assembly and the main frame.
- Push the pivot rod cap onto the top of the pivot rod. Use a rubber mallet or a hammer to gently tap the cap into the hole. (**Note:** If you use a hammer, be sure to place a cloth over the pivot rod cap to protect the powder coating on the main frame.)
- To attach the rear wheels, first remove the black plastic protective cap at the end of the axle, and discard. Turn the trike upside-down and find the notch at one end of the frame's axle tube. Slide the end of the axle into that end of the tube, and turn it until the screw on the axle fits into the notch of the tube. Next, slide the larger flat washer over the axle, followed by the wheel and then the remaining flat washer. Screw the nut onto the axle and use the wrench to tighten the nut securely.
- Position the hubcap over the end of the axle. Fit the spring washer into the top of the hubcap, then insert the screw and use the Allen wrench to tighten the screw firmly. That's it—your Easy-Ride First Trike is now ready for use!

Before You Ride...

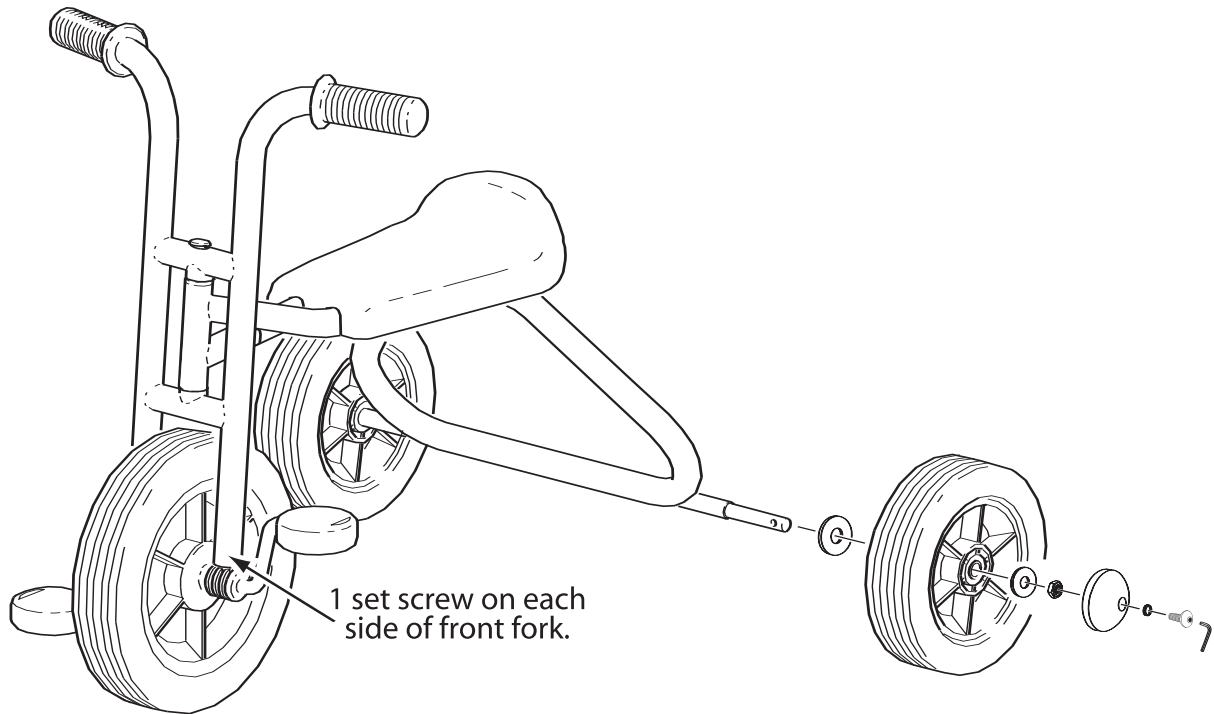

Before children ride their new vehicle, have an adult use the enclosed tools to tighten all pre-assembled hardware. Please refer to the above illustration to help you locate the set screws that require tightening. Once you have completed this step, the vehicle will be ready for use! To maximize safety, check the screws regularly, and tighten as necessary.

Note: It is recommended that riders should always wear a properly fitted helmet that complies with U.S. Consumer Product Safety Commission (CPSC) Standard 16 CFR 1203.

To order replacement parts, see back.

How to Order Replacement Parts for Your First Trike

After your warranty has expired, a time may come when a part needs to be replaced because of normal wear and tear.

1. Use the diagram below to determine exactly what part needs to be replaced.
2. Locate the part number on the list at right.
3. For prices and ordering information, contact our Customer Service Department at (800) 428-4414.

PARTS LIST

| | | | |
|------|--|------|--|
| M105 | Pedals (set of 2) | M117 | Rear axle with 2 hubcaps and hardware |
| M108 | Pivot rod cap only | M118 | Seat with bolt, washer, plastic washer, and wrench |
| M109 | Hubcaps (2) with hardware (Allen key, 4 washers, 2 spring washers, nut, and screw) | M119 | Handgrips (set of 2) |
| M114 | Front fork with complete front wheel assembly | M120 | Pivot rod and cap |
| M115 | Front wheel with tire, pedal bar assembly, and 2 pedals | M121 | Seat bolt with washer, plastic washer, and wrench |
| M116 | Rear wheel with hardware | M122 | Pinch guards (2), nylock rivet screws (2), Allen key |
| | | M153 | Main frame |

This detailed drawing indicates every individual part that makes up your new Easy-Ride First Trike.

