



Easy-Ride™ 3-Wheel Scooter

Engineered to stay on the move—all day, every day, year after year—your 3-Wheel Scooter is one of the most durable institution-quality vehicles available. And it's guaranteed for five full years!

The sturdy 3-Wheel Scooter is easy for little ones to maneuver. It features a wide platform, lightweight rims, and two large rear wheels that offer extra stability for young riders.

Easy-Ride 3-Wheel Scooter Unlimited Warranty

*We think you've just purchased the toughest 3-Wheel Scooter in the world.
Here's what we'll do to prove it!*

At no cost, we will replace ANY parts that break for ANY reason during the first five years you have the Easy-Ride 3-Wheel Scooter.

We have a complete stock of all Easy-Ride 3-Wheel Scooter parts so that you can buy anything you need from us after this warranty expires. See the parts list inside.

Direct all requests to: Lakeshore Learning Materials
2695 E. Dominguez St.
Carson, CA 90895
(800) 428-4414

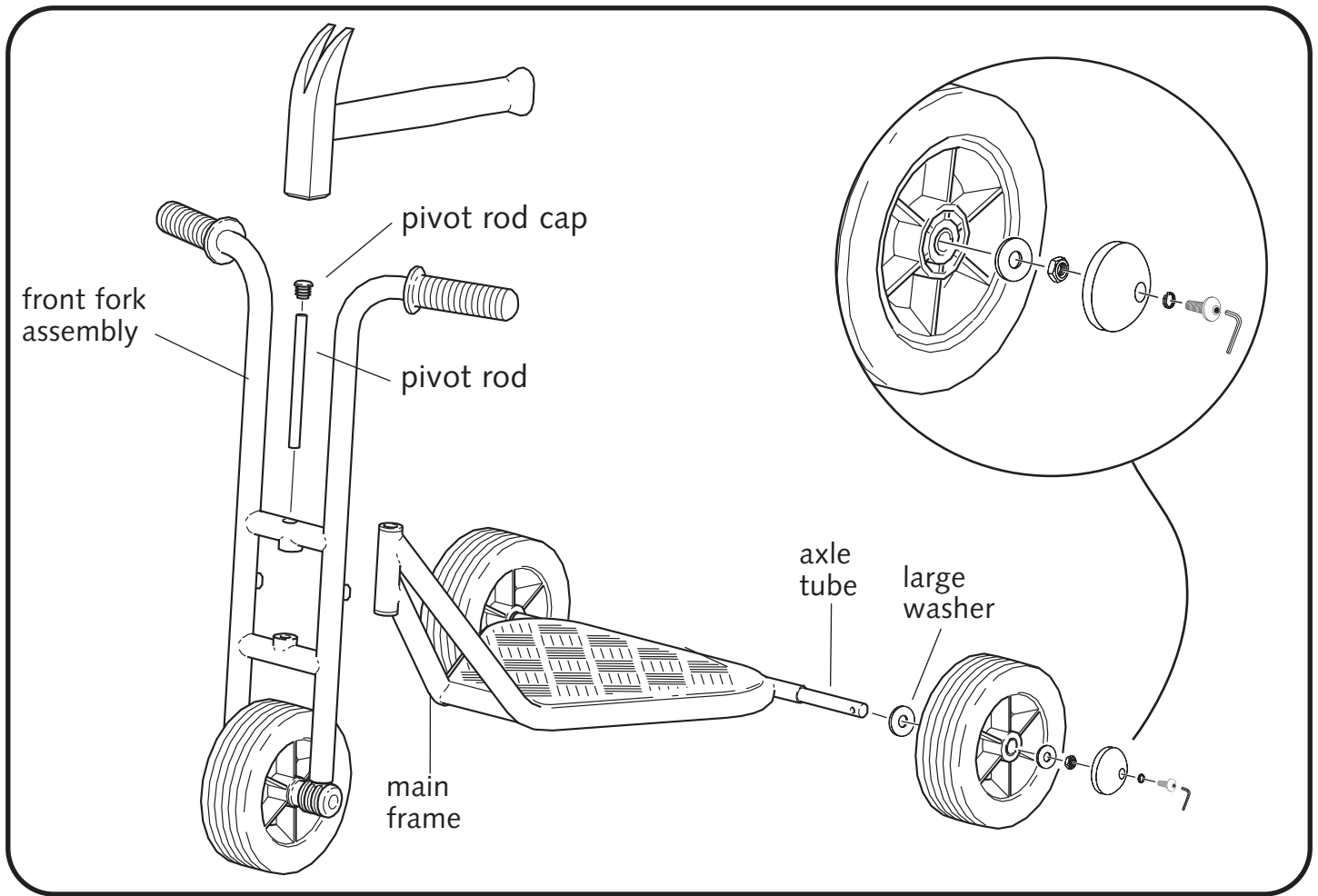

How to Assemble Your Easy-Ride 3-Wheel Scooter

To assemble your scooter, all you need is a hammer. (We've provided a wrench and an Allen key.)

- Position the front fork assembly and the main frame so that the pivot rod holes are aligned. Be sure the black rubber stoppers on the front fork assembly are facing the rear of the scooter. Next, insert the pivot rod through the holes in the front fork assembly and the main frame.
- Push the pivot rod cap onto the top of the pivot rod. Use a hammer to gently tap the cap into the hole.
- To attach the rear wheels, first unscrew and discard the black plastic cap that protects the end of the axle. Turn the scooter upside-down and find the notch at one end of the frame's axle tube. Slide the end of the axle into that end of the tube, and turn it until the screw on the axle fits into the notch of the tube. Next, slide the larger flat washer over the axle, followed by the wheel and then the remaining flat washer. Screw the nut onto the axle and use the wrench to tighten the nut securely.
- Position the hubcap over the end of the axle. Fit the spring washer into the top of the hubcap, then insert the screw and use the Allen key to tighten the screw firmly. That's it—your Easy-Ride 3-Wheel Scooter is now ready for use!

Before You Ride...

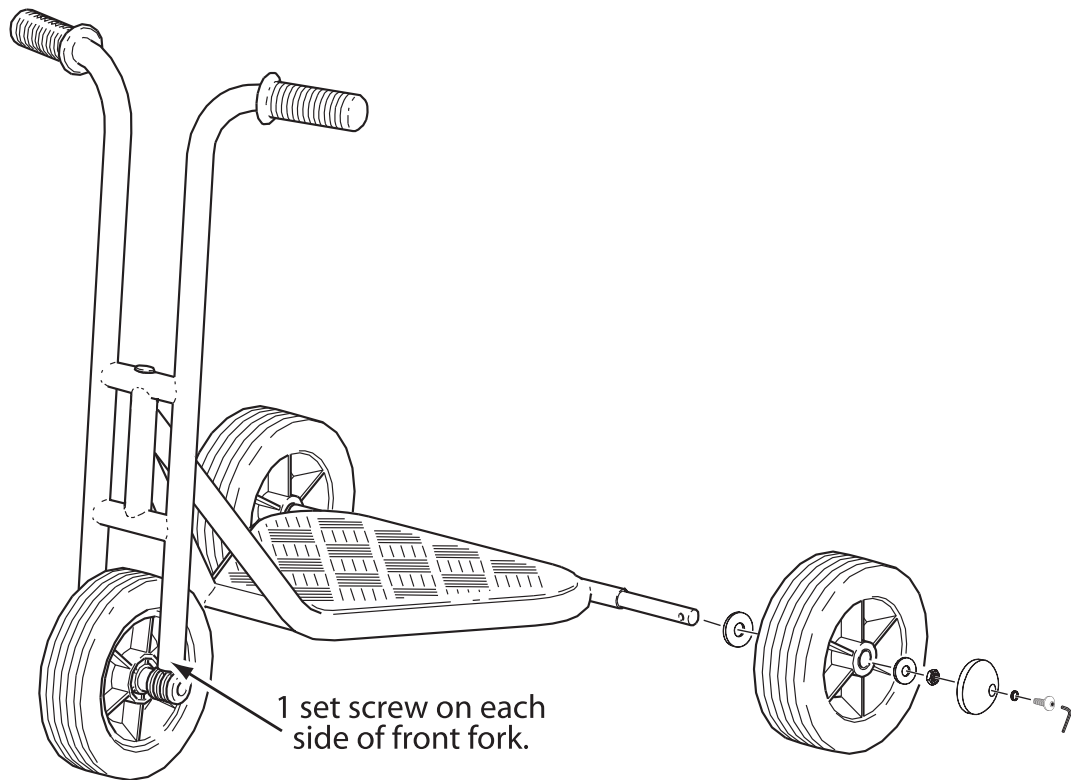

Before children ride their new vehicle, have an adult use the enclosed tools to tighten all pre-assembled hardware. Please refer to the above illustration to help you locate the set screws that require tightening. Once you have completed this step, the vehicle will be ready for use! To maximize safety, check the screws regularly, and tighten as necessary.

Note: It is recommended that riders should always wear a properly fitted helmet that complies with U.S. Consumer Product Safety Commission (CPSC) Standard 16 CFR 1203.

To order replacement parts, see back.

How to Order Replacement Parts for Your 3-Wheel Scooter

After your warranty has expired, a time may come when a part needs to be replaced because of normal wear and tear.

1. Use the diagram below to determine exactly what part needs to be replaced.
2. Locate the part number on the list at right.
3. For prices and ordering information, contact our Customer Service Department at (800) 428-4414.

PARTS LIST			
M108	Pivot rod cap only	M122	Pinch guards (2), nylock rivet screws (2), Allen key
M109	Hubcaps (2) with hardware (Allen key, 4 washers, 2 spring washers, 2 nuts, and 2 screws)	M126	Complete front fork assembly with wheel
M116	Rear wheel with hardware	M127	Front wheel with tire and fork connectors
M117	Rear axle with 2 hubcaps and hardware	M128	Foot plate with nylock screws (5) and Allen key
M119	Handgrips (set of 2)	M152	Main frame
M120	Pivot rod and cap		

This detailed drawing indicates every individual part that makes up your new Easy-Ride 3-Wheel Scooter.

